

Sistema Girofix Castanha

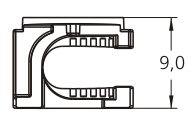

RAS
RAS
38



5511.2

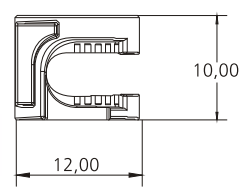
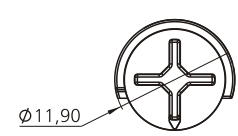

5513.2

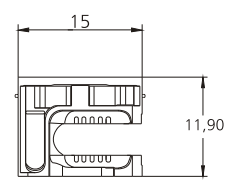

5511.2

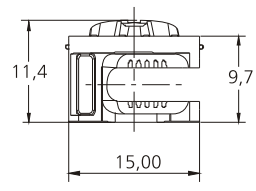

1333.2



Ref.	Produto	Material	Embalagem
5511.2	Castanha do girofix 15 mm	zamac	2.000
1333.2	Castanha rasa girofix 15 mm	zamac	2.000
5513.2	Castanha do mini girofix 12 x 10	zamac	4.000
5211.2	Castanha mini girofix 12 x 9 p/ tapa furo	zamac	4.000

Tampas, Tapa Furo e Bucha Girofix

Sistema Girofix



Detalhes que fazem diferença no acabamento dos móveis.



A tampa de castanha do Sistema Girofix dá o acabamento perfeito para os móveis.

Faz parte do kit do Sistema Girofix de Fixação.

Feito de nylon, tem 11 opções de cores para combinar com a cor da madeira ou revestimento.

A montagem é bem simples. Basta encaixar.

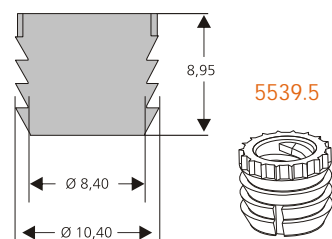

Produto	Cor	Código*
	Marfim	2
	Marrom e Tabaco	3
	Cerejeira	4
	Preto	5
	Champagne	6
	Branco	7
	Mogno	8
	Cinza	CZ
	Mel	ML
	Bege Salmão	BS
	Marfim Amarelo	MA
	Marfim Real	MR

* Códigos referentes às cores disponíveis para tampa de nylon

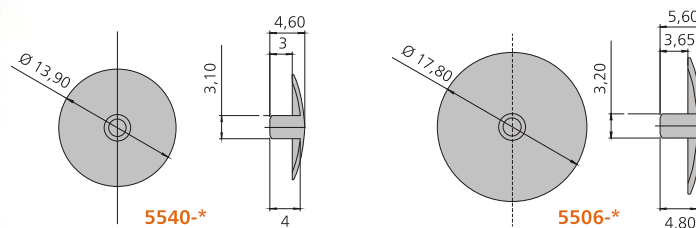

Ref.	Produto	Material	Embalagem
5506.*	Tampa do girofix	nylon	2,000
5540.*	Tampa do mini girofix	nylon	2,000
5213.*	Tapa furo p/ castanha 12	nylon	2,000
5539.5	Bucha do girofix 9 mm*	nylon	4,000



Vidro Albr...

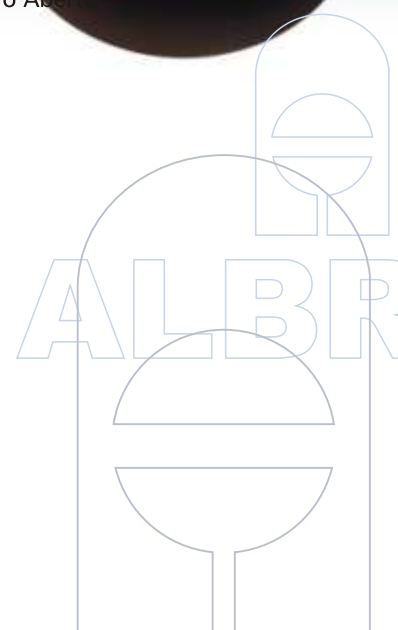

G Sistema Girofix

Pino com Rosca Soberba

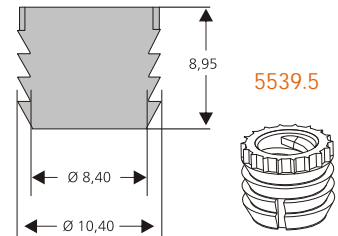

Para utilizar o Conjunto Girofix sem bucha, efetuar a furação com $\varnothing = 5\text{mm}$.

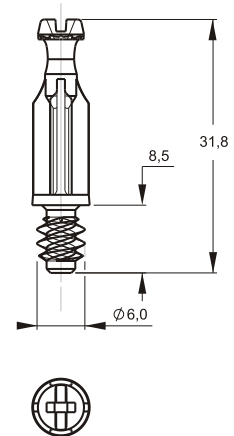
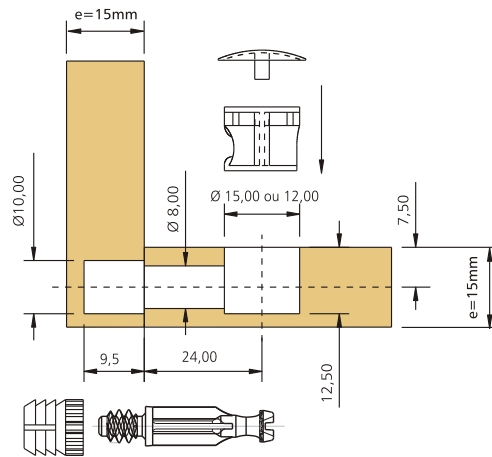

Montagem passo a passo



- 1-Efetue a Furação conforme indicado ao lado.
- 2-Insira cuidadosamente a castanha e a bucha.
- 3-Rosqueie o pino na bucha com a mão.
- 4-Efetue a montagem das partes.
- 5-A seta indicará a posição relativa ao pino.

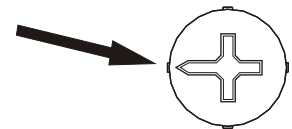

Ref.	Produto	Material	Embalagem
5510.2	Pino de aço longo com rosca soberba	aço	1.000
5512.2	Pino do girofix com rosca soberba zamac	zamac	2.000
5541.2	Pino do girofix M6 aço	aço	2.000
1493.2	Pino do girofix de aço laminado rosca soberba	aço	4.000

ALBRASLBR

Pino de Aço



5510.2

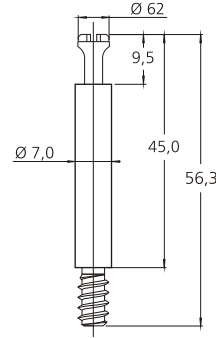
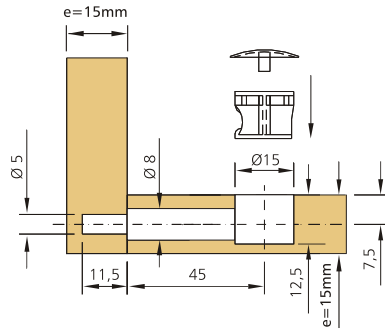

Pino Laminado



1493.2

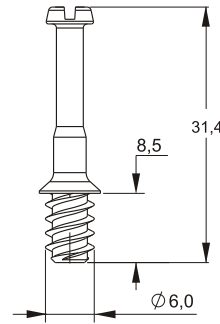
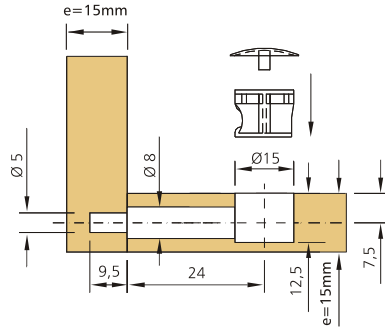

Pino de Aço



5541.2

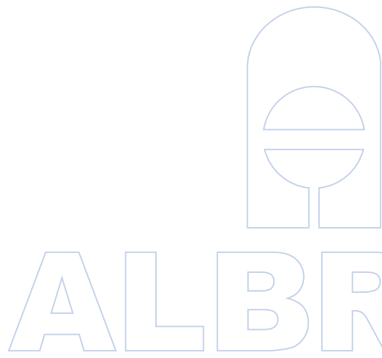
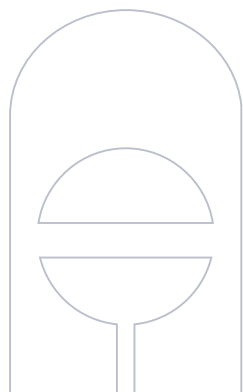
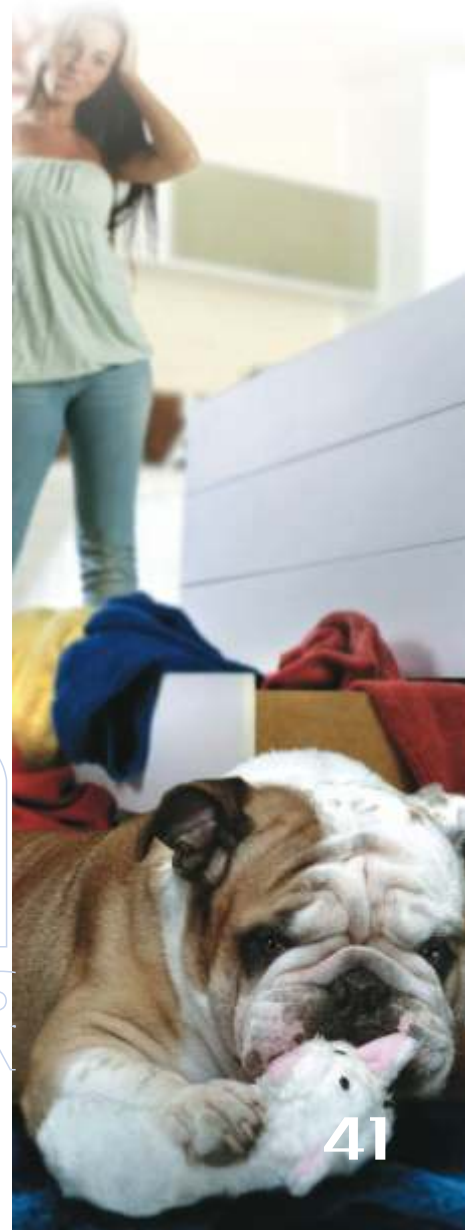
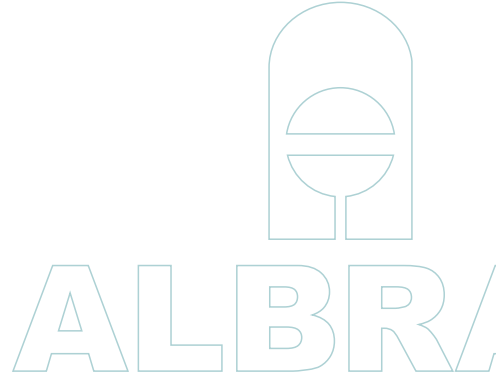
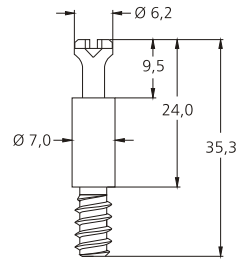
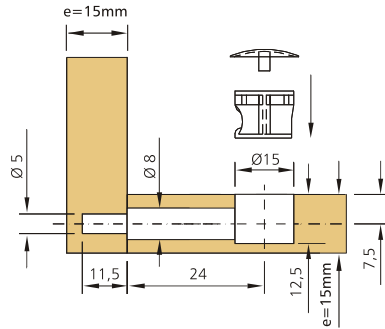

Sistema Girofix

Pino Duplo

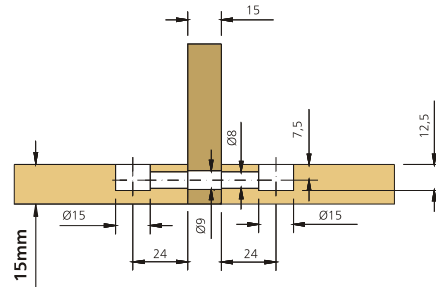

5516.2

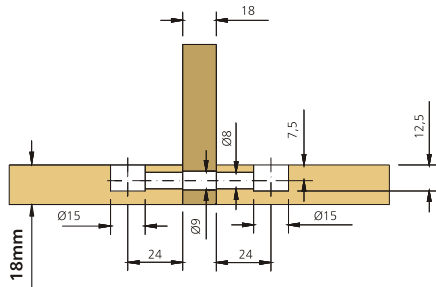
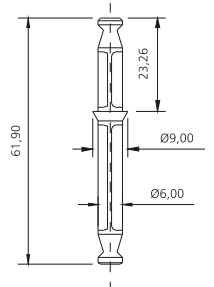

5507.2

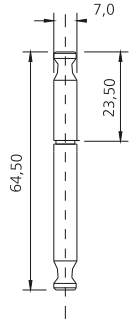

Montagem passo a passo

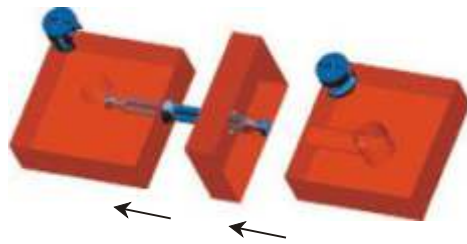

- 1- Efetue a Furação conforme indicado acima.
- 2- Insira cuidadosamente as castanhas e o pino.
- 3- Efetue a montagem das partes.
- 4- Vire as castanhas. A seta indicará a posição relativa ao pino.

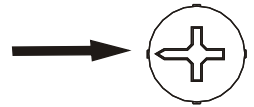

Esquema de montagem do sistema girofix pino duplo

Ref.	Produto	Material	Embalagem
5516.2	Pino duplo zamac	zamac	1.000
5507.2	Pino girofix duplo aço	aço	500

BRAS

ALBRAS